



# Ambrosia

## Ciszak Dalmas

marset



**Ambrosia A 60 left**

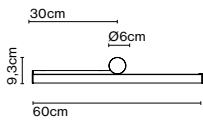

**Ambrosia A 60 right**

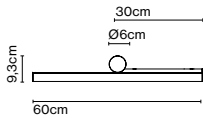

**Disk accessory**



info@marset.com  
www.marset.com

**Ambrosia A 90 left**

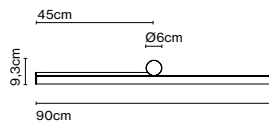

**Ambrosia A 90 right**

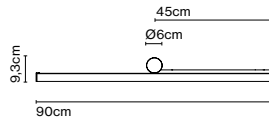

**Ambrosia A 210**

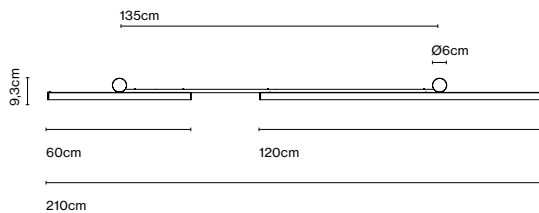

**Power supply (RSC)**

- Power supply 20W - 24V - Clase II - Triac
- Power supply 50W - 24V - Clase II - Triac
- Power supply 35W - 24V - Clase II - DALI
- Power supply 60W - 24V - Clase II - DALI

**Aluminium structure. Methacrylate light tube.**

- Black
- Matt Gold

**Ambrosia A 60**

- Light source Ambrosia 22K:  
LED SMD 24Vdc 9,6W 2200K CRI80 1058lm
- Light source Ambrosia 27K:  
LED SMD 24Vdc 9,6W 2700K CRI90 1014lm
- Light source Ambrosia 30K: LED SMD 24Vdc  
9,6W 3000K CRI90 1028lm

Luminaire Ambrosia A 60:  
(Power supply not included)

**Ambrosia A 90**

- Light source Ambrosia 22K:  
LED SMD 24Vdc 14,4W 2200K CRI80 1587lm
- Light source Ambrosia 27K:  
LED SMD 24Vdc 14,4W 2700K CRI90 1521lm
- Light source Ambrosia 30K:  
LED SMD 24Vdc 14,4W 3000K CRI90 1692lm

Luminaire Ambrosia A 90:  
(Power supply not included)

**Ambrosia A 210**

- Light source Ambrosia 22K:  
LED SMD 24Vdc 28,8W 2200K CRI80 3174lm
- Luminaire Ambrosia 22K:  
(Power supply not included) 2802lm

- Light source Ambrosia 27K:  
LED SMD 24Vdc 28,8W 2700K CRI90 3042lm
- Luminaire Ambrosia 27K:  
(Power supply not included) 2812lm

- Light source Ambrosia 30K:  
LED SMD 24Vdc 28,8W 3000K CRI90 3384lm
- Luminaire Ambrosia 30K:  
(Power supply not included) 2865lm

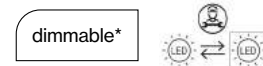

\*It depends on the purchased power supply, Triac o DALI. 24V remote power supply to be ordered separately.

The starting point for the Ambrosia was to bring back the traditional Linestra lamp to update it and show that a technical, resolute design can also be poetic.